

- Map 1 SR 3123 - Friendly Chapel Rd
- Map 2 SR 3160 - Rustic House Ln
- Map 3 SR 3194 - Rothwood Acres Rd
- Map 4 SR 3154 - Flora Vista Rd
- Map 5 SR 3137 - Watkins Grove Pt
- Map 6 SR 3177 - Circleview Dr
- Map 7 SR 3203 - Pine Vista Ln
- Map 8 SR 3209 - Nelson Farm Ct
- Map 9 SR 3034 - Cyrus Rd
- Map 10 SR 3081 - Nancy Jean Rd
- Map 11 SR 3186 - Myrawood Dr
- Map 12 SR 3187 - Lady Ln
- Map 13 SR 3080 - Tom Rd
- Map 14 SR 3198 - Wright-Yow Ln
- Map 15 SR 3135 - Baity Bend Rd
- Map 16 SR 3075 - Land Rd
- Map 17 SR 3076 - Hooting Hollow Rd
- Map 18 SR 3084 - Bailey Rd
- Map 19 SR 3083 - Sumac Rd
- Map 20 SR 3126 - Farmer Rd

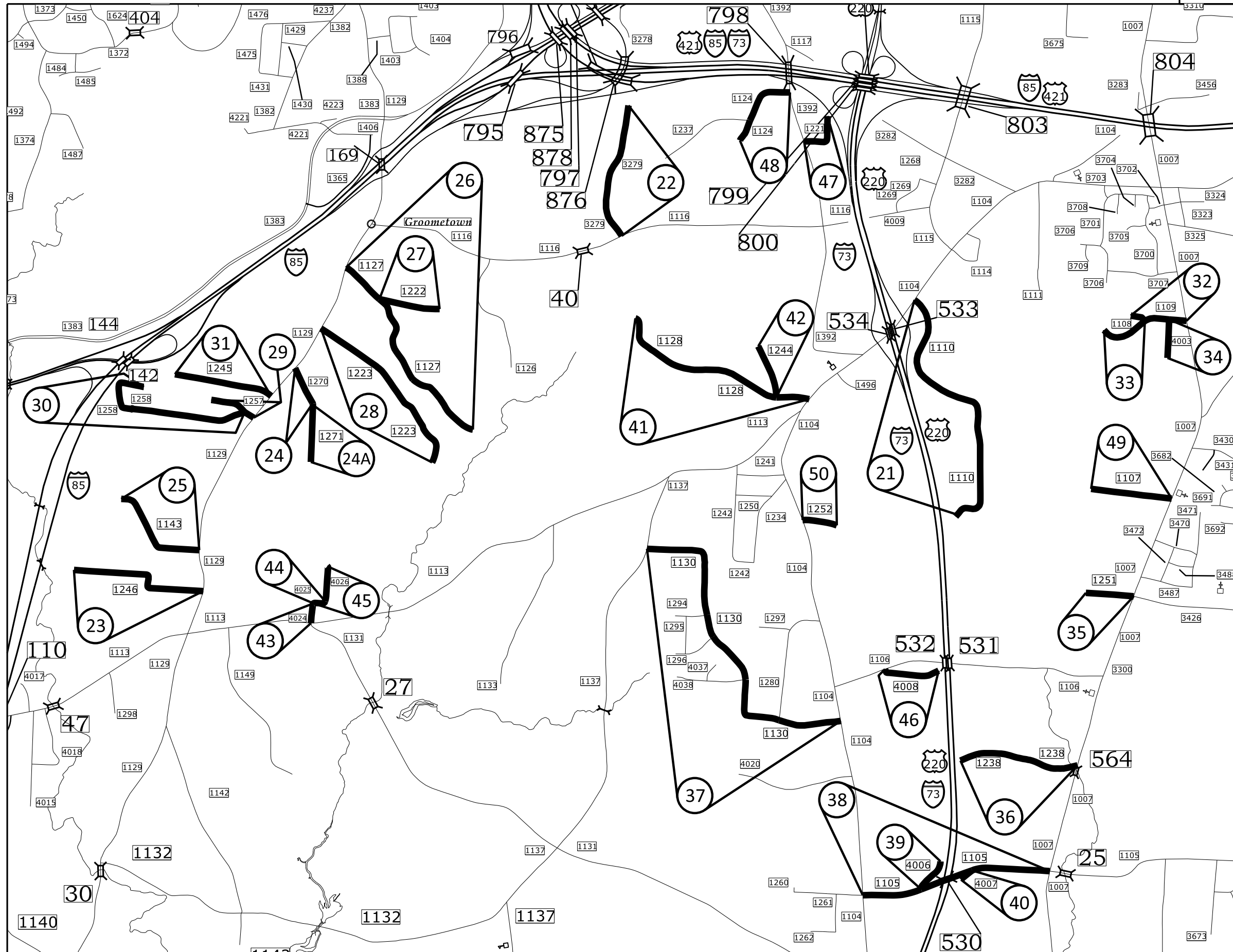

- Map 21 SR 1110 - Friendly Farms Rd
- Map 22 SR 3279 - Viewmont Dr
- Map 23 SR 1246 - Brandy Rd
- Map 24 SR 1270 - Wadena Dr
- Map 24A SR 1271 - Wadena Ct
- Map 25 SR 1143 - Cimmaron Ct
- Map 26 SR 1127 - Winford Rd
- Map 27 SR 1222 - Honeycutt Ct
- Map 28 SR 1223 - Sweetwater Ct
- Map 29 SR 1257 - Bluebonnet Dr
- Map 30 SR 1258 - Southview Dr
- Map 31 SR 1245 - Sedgehill Ct
- Map 32 SR 1109 - Pitman Rd
- Map 33 SR 1108 - Ronald Rd
- Map 34 SR 4003 - Coefield Rd
- Map 35 SR 1251 - W Sheraton Park Rd
- Map 36 SR 1238 - Kentmere Rd
- Map 37 SR 1130 - Newman Davis Rd
- Map 38 SR 1105 - W Steeple Chase Rd
DO NOT Pave Bridge #530
- Map 39 SR 4006 - Steeple Chase Ct
- Map 40 SR 4007 - Service Road
- Map 41 SR 1128 - Concord Church Rd
- Map 42 SR 1244 - Tokay Court/
Bigpoplar Ln
- Map 43 SR 4024 - Purdue Rd
- Map 44 SR 4025 - Centenary Rd/Brook Rd
- Map 45 SR 4026 - Brook Rd
- Map 46 SR 4008 - Sutton Ct
- Map 47 SR 1221 - Norman Park Rd
- Map 48 SR 1124 - Roberts Court
- Map 49 SR 1107 - Halsbrook Rd
- Map 50 SR 1252 - Benedict Rd

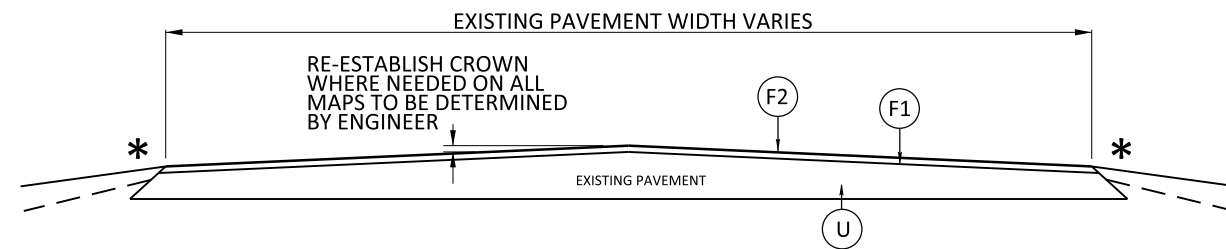

*** NOTE:**
THE SURFACE TO BE TREATED SHALL BE CLEANED TO THE SATISFACTION OF THE INSPECTOR PRIOR TO STARTING ON EACH MAP

TYPICAL SECTION NO. 1

Map 1	SR 3123 - Friendly Chapel Rd	Map 26	SR 1127 - Winford Rd
Map 2	SR 3160 - Rustic House Ln	Map 27	SR 1222 - Honeycutt Ct
Map 3	SR 3194 - Rothwood Acres Rd	Map 28	SR 1223 - Sweetwater Ct
Map 4	SR 3154 - Flora Vista Rd	Map 29	SR 1257 - Bluebonnet Dr
Map 5	SR 3137 - Watkins Grove Pt	Map 30	SR 1258 - Southview Dr
Map 6	SR 3177 - Circlevue Dr	Map 31	SR 1245 - Sedgemoor Ct
Map 7	SR 3203 - Pine Vista Ln	Map 32	SR 1109 - Pitman Rd
Map 8	SR 3209 - Nelson Farm Ct	Map 33	SR 1108 - Ronald Rd
Map 9	SR 3034 - Cyrus Rd	Map 34	SR 4003 - Coefield Rd
Map 10	SR 3081 - Nancy Jean Rd	Map 35	SR 1251 - W Sheraton Park Rd
Map 11	SR 3186 - Myrawood Dr	Map 36	SR 1238 - Kentmere Rd
Map 12	SR 3187 - Lady Ln	Map 37	SR 1130 - Newman Davis Rd
Map 13	SR 3080 - Tom Rd	Map 38	SR 1105 - W Steeple Chase Rd
Map 14	SR 3198 - Wright-Yow Ln		DO NOT Pave Bridge #530
Map 15	SR 3135 - Baity Bend Rd	Map 39	SR 4006 - Steeple Chase Ct
Map 16	SR 3075 - Land Rd	Map 40	SR 4007 - Service Road
Map 17	SR 3076 - Hooting Hollow Rd	Map 41	SR 1128 - Concord Church Rd
Map 18	SR 3084 - Bailey Rd	Map 42	SR 1244 - Tokay Court/Bigpoplar Ln
Map 19	SR 3083 - Sumac Rd	Map 43	SR 4024 - Purdue Rd
Map 20	SR 3126 - Farmer Rd	Map 44	SR 4025 - Centenary Rd/Brook Rd
Map 21	SR 1110 - Friendly Farms Rd	Map 45	SR 4026 - Brook Rd
Map 22	SR 3279 - Viewmont Dr	Map 46	SR 4008 - Sutton Ct
Map 23	SR 1246 - Brandy Rd	Map 47	SR 1221 - Norman Park Rd
Map 24	SR 1271 - Wadena Ct	Map 48	SR 1124 - Roberts Court
Map 25	SR 1143 - Cimmaron Ct	Map 49	SR 1107 - Halsbrook Rd
		Map 50	SR 1252 - Benedict Rd

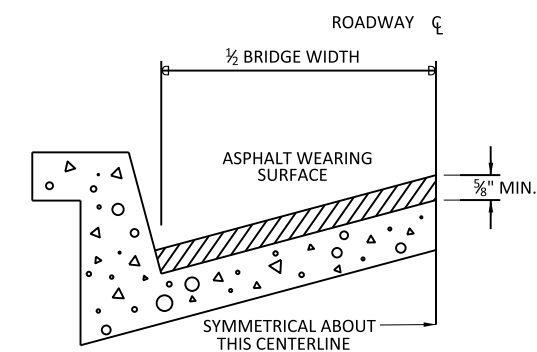

BRIDGE HALF TYPICAL SECTION

FOR BRIDGES WITH FLOOR DRAINS, CARE SHALL BE EXERCISED IN PLACING THE WEARING SURFACE AROUND FLOOR DRAINS SO AS NOT TO HINDER EFFECTIVE DRAINAGE. ALL DRAINS SHALL BE LEFT OPEN. THE PROPOSED WEARING SURFACE SHALL VARY IN THICKNESS AS NECESSARY TO PROVIDE A SMOOTH RIDING SURFACE. A THICKNESS OF NOT LESS THAN 3/8" SHALL BE PROVIDED. THE MAXIMUM THICKNESS SHALL PREFERABLY BE 1-1/2" UNLESS IT IS IMPRACTICAL TO PROVIDE A SMOOTH RIDING SURFACE OTHERWISE.

NOTES
ALL UNPAVED S.R. ROUTES TO BE SURFACED 50' FROM EDGE OF PAVEMENT OF MAIN PROJECT.
ALL PAVED S.R. ROUTES TO BE RESURFACED TO END OF RADDII, OR AS DIRECTED BY THE ENGINEER. EDGES, PAVEMENT WIDENING, INTERSECTIONS AND BRIDGE FLARES ARE INCLUDED IN THE SUMMARY OF QUANTITIES. BRIDGES TO BE RESURFACED AT LOCATIONS AND DEPTH AS DIRECTED BY THE ENGINEER.

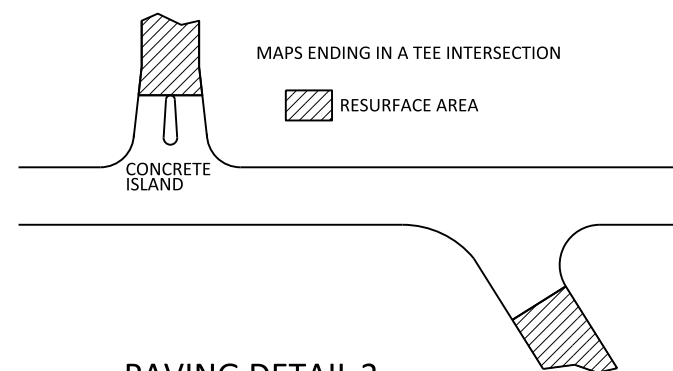

PAVING DETAIL 2
MAIN LINE NOT BEING RESURFACED

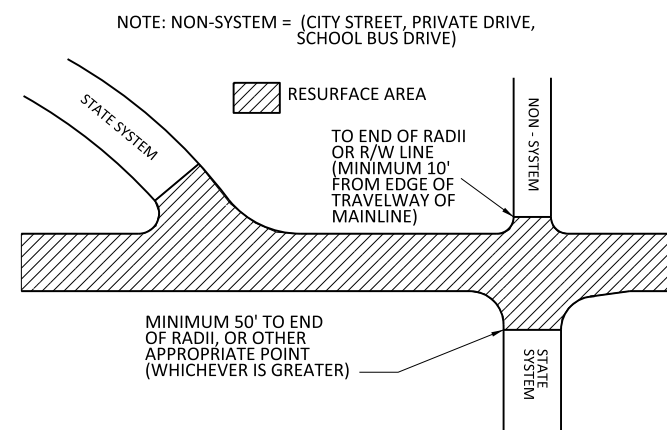

PAVING DETAIL 1
MAIN LINE IS BEING RESURFACED

PAVEMENT SCHEDULE

F1	PROPOSED ASPHALT SURFACE TREATMENT, DOUBLE SEAL
F2	PROPOSED FOG SEAL
U	EXISTING PAVEMENT

SIGNING FOR ASPHALT SURFACE TREATMENT

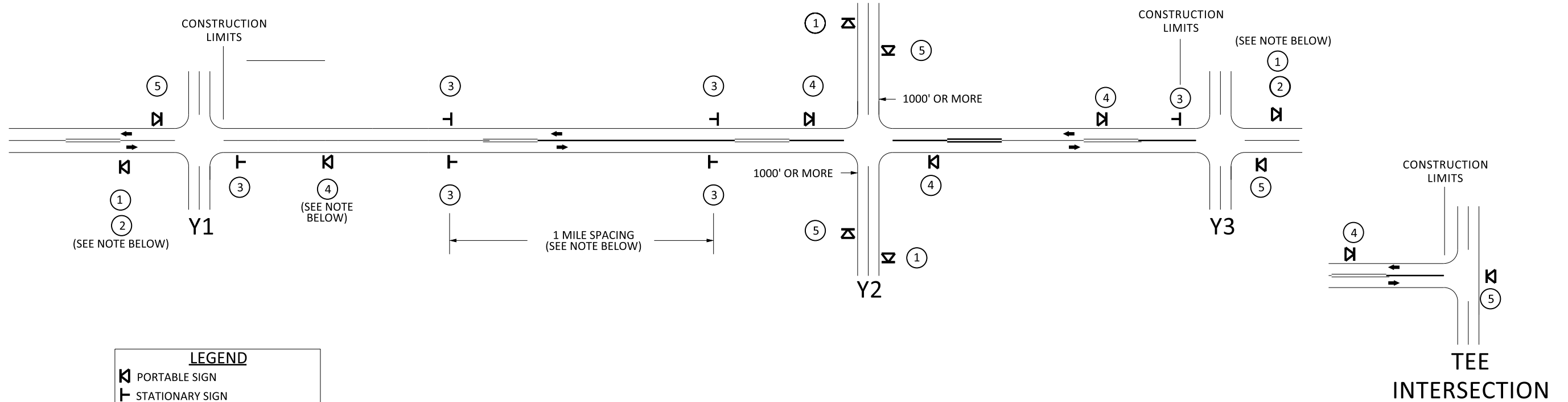

LEGEND	
	PORTABLE SIGN
	STATIONARY SIGN
	DIRECTION OF TRAFFIC FLOW

MAINLINE (-L-) SIGNING

-Y- LINE SIGNING

SIGNING NOTES AND PLACEMENT PER DIRECTION	1		PLACE 1000' PRIOR TO BEGINNING OF CONSTRUCTION LIMITS. ONLY USED ON -Y- LINES IF RESURFACING LIMITS EXTEND 1000' ALONG -Y- LINE.
	2		#2 SIGN ONLY USED WHEN RESURFACING LIMITS ARE 2 OR MORE MILES IN LENGTH. ROUND UP TO NEXT WHOLE NUMBER.(NO FRACTIONAL OR DECIMAL NUMBERS)
	3		- ALTERNATE THE FOLLOWING TWO SIGNS: - STARTING WITH "LOOSE GRAVEL" (WB-7) FOLLOWED BY "UNMARKED PAVEMENT". - PLACE INITIALLY AT THE CONSTRUCTION LIMITS AND SPACED 1 MILE APART THEREAFTER. - AT TEE INTERSECTIONS INSTALL INITIALLY 0.5 MILES FROM INTERSECTION AND SPACE 1 MILE APART THEREAFTER.
	4		THESE ARE FOR -Y- LINES THAT ARE "THROUGH" ROADWAYS. DEAD END AND SUBDIVISION ROADS ARE NOT "THROUGH" ROADWAYS. INSTALL 500' +/- FROM EACH -Y- LINE APPROACH AS SHOWN ABOVE. FOR MULTIPLE -Y- LINES THAT ARE SEPARATED BY 0.25 MILES OR LESS, TREAT AS A SINGLE UNIT AND INSTALL WITHIN 500' OF EACH APPROACH. A MAXIMUM OF 2 SIGN SETS PER MILE. DO NOT INSTALL WHEN -Y- LINES ARE WITHIN 0.5 MILES FROM "END ROAD WORK" SIGN.
	5		PLACE 500' FOLLOWING THE END OF CONSTRUCTION LIMITS.

NO REQUIRED STATIONARY SIGNING FOR THE FOLLOWING -Y- LINE CONDITIONS:

- 1) LESS THAN 1000' OF RESURFACING ALONG -Y- LINE
- 2) SUBDIVISION ROADS
- 3) DEAD END ROADS

WHEN PAVING/CONSTRUCTION ACTIVITIES PROCEED ACROSS AN UNSIGNED -Y- LINE, ADVANCE WARNING PORTABLE SIGNS SHALL BE USED ALONG THE -Y- LINE AS SHOWN BELOW. REMOVE UPON COMPLETION OF WORK.

PLACED 500' IN ADVANCE OF FLAGGER.

PLACED 250' IN ADVANCE OF FLAGGER.

THE ABOVE SIGNS ARE ALL THAT ARE REQUIRED FOR A CONTRACTOR TO BEGIN A RESURFACING CONTRACT. ANY ADDITIONAL SIGNS REQUESTED BY NCDOT DIVISIONS SHALL BE INSTALLED WITHIN 7 BUSINESS DAYS OF THE START OF CONTRACT WORK.

MAPS LESS THAN 2 MILES

FOR AST RESURFACING MAPS WITH CONSTRUCTION LIMITS LESS THAN 2 MILES IN LENGTH, USE A STATIONARY "LOOSE GRAVEL" SIGN AT THE BEGINNING CONSTRUCTION LIMIT FOLLOWED BY AN "UNMARKED PAVEMENT" SIGN MIDWAY THROUGH AND AN "END ROAD WORK" SIGN AT THE END CONSTRUCTION LIMIT.



RESURFACING
ADVANCE WARNING SIGNS
FOR
RURAL AND SUBURBAN
2 LANE ROADWAYS

2022 Guilford County AST

Project No.	Sheet No.
2022CPT.07.22.20412	5

Map #	SR # Name	Description	Length	Width	1803500000-E	1820000000-E	1838000000-E	1838500000-N	4413000000-E	4457000000-N	4890000000-E	4890000000-E	4890000000-E
					ASPHALT SURFACE TREATMENT, DOUBLE SEAL	ASPHALT SURFACE TREATMENT, FOG SEAL	EMULSION FOR ASPHALT SURFACE TREATMENT	VACUUM TRUCK	WORK ZONE ADVANCE/GENERAL WARNING SIGNING	TEMPORARY TRAFFIC CONTROL	6" HOT SPRAY THERMO (WHITE)	4" HOT SPRAY THERMO (WHITE)	4" HOT SPRAY THERMO (YELLOW)
			Miles	(Feet)	SY	SY	GAL	WK	SF	LS	LF	LF	LF
Map 1	SR 3123 - Friendly Chapel Rd	From SR 3036 - Sharpe Rd TO DEAD END	0.29	20.0	3,411	3,411	1,876	3	33	1			
Map 2	SR 3160 - Rustic House Ln	From SR 3037 - E Lee St TO DEAD END	0.15	19.5	1,712	1,712	205		17				
Map 3	SR 3194 - Rothwood Acres Rd	From SR 3037 - E Lee St TO END MAINT.	0.20	20.0	2,400	2,400	1,320		23				
Map 4	SR 3154 - Flora Vista Rd	From SR 3037 - E Lee St TO END MAINT.	0.16	18.0	1,720	1,720	946		19				
Map 5	SR 3137 - Watkins Grove Pt	From SR 3037 - E Lee St TO END MAINT.	0.23	18.5	2,549	2,549	1,402		27				
Map 6	SR 3177 - Circleview Dr	From SR 3029 - Youngs Mill Rd TO SR 3203 - Pine Vista Ln	0.12	20.0	1,389	1,389	764		14				
Map 7	SR 3203 - Pine Vista Ln	From SR 3157 - Farlow Dr TO DEAD END	0.20	19.0	2,217	2,217	1,219		23				
Map 8	SR 3209 - Nelson Farm Ct	From SR 3039 - Nelson Farm Rd TO DEAD END	0.06	18.0	620	620	341		7				
Map 9	SR 3034 - Cyrus Rd	From SR 1005 - Alamance Church Rd TO DEAD END	0.24	18.0	2,500	2,500	1,375		27				
Map 10	SR 3081 - Nancy Jean Rd	From SR 3088 - Thacker Dairy Rd TO END MAINT.	0.59	19.2	6,635	6,635	3,649		66				
Map 11	SR 3186 - Myrawood Dr	From SR 3088 - Thacker Dairy Rd TO SR 3187 - Lady Ln	0.27	20.0	3,222	3,222	1,772		31				
Map 12	SR 3187 - Lady Ln	From END MAINT TO DEAD END	0.30	17.5	3,343	3,343	2,009		34				
Map 13	SR 3080 - Tom Rd	From SR 3088 - Thacker Dairy Rd TO END MAINT.	0.20	18.0	2,120	2,120	1,166		23				
Map 14	SR 3198 - Wright-Yow Ln	From SR 3078 - Millpoint Rd TO DEAD END	0.22	20.0	2,611	2,611	1,436		25				
Map 15	SR 3135 - Baity Bend Rd	From SR 3000 - Mcconnell Rd TO DEAD END	0.48	19.5	5,681	5,681	3,210		55				
Map 16	SR 3075 - Land Rd	From SR 3076 - Hooting Hollow Rd TO END MAINT	0.38	18.0	4,150	4,150	2,365		43				
Map 17	SR 3076 - Hooting Hollow Rd	From SR 3000 - Mcconnell Rd TO END MAINT	0.32	18.0	3,380	3,380	406		36				
Map 18	SR 3084 - Bailey Rd	From SR 1005 - Alamance Church Rd TO END MAINT.	0.48	18.0	5,500	5,500	3,245		55				
Map 19	SR 3083 - Sumac Rd	From SR 3084 - Bailey Rd TO END MAINT.	0.33	17.5	3,483	3,483	1,971		37				
Map 20	SR 3126 - Farmer Rd	From SR 3093 - Old Julian Rd TO END MAINT.	0.22	16.5	2,099	2,099	1,155		25				
Map 21	SR 1110 - Friendly Farms Rd	From SR 1104 - Old Randleman Rd TO END MAINT	1.14	20.5	13,817	13,817	7,682		128			12,000	12,000
Map 22	SR 3279 - Viewmont Dr	From SR 1116 - Bishop Rd TO END MAINT	0.63	21.6	7,920	7,920	4,356		70				
Map 23	SR 1246 - Brandy Rd	From SR 1129 - Groometown Rd TO END MAINT	0.60	20.0	7,067	7,067	3,887		68				
Map 24	SR 1270 - Wadena Dr	From SR 1129 - Groometown Rd TO SR 1271 - Wadena Ct	0.16	20.8	1,988	1,988	1,093		19				
Map 24A	SR 1271 - Wadena Ct	From SR 1270 - Wadena Dr TO END MAINT	0.25	20.5	2,961	2,961	1,629		28				
Map 25	SR 1143 - Cimmaron Ct	From SR 1129 - Groometown Rd TO END MAINT	0.40	19.0	4,569	4,569	2,559		46				
Map 26	SR 1127 - Winford Rd	From SR 1129 - Groometown Rd TO END MAINT	0.59	18.5	6,657	6,657	3,790		67				
Map 27	SR 1222 - Honeycutt Ct	From SR 1127 - Winford Rd TO END MAINT	0.24	21.0	3,710	3,710	2,477		27				
Map 28	SR 1223 - Sweetwater Ct	From SR 1129 - Groometown Rd TO END MAINT	0.79	20.0	9,222	9,222	5,072		89				
Map 29	SR 1257 - Bluebonnet Dr	From SR 1129 - Groometown Rd TO END MAINT	0.19	20.0	2,728	2,728	1,803		21				
Map 30	SR 1258 - Southview Dr	From SR 1257 - Bluebonnet Dr TO END MAINT	0.73	19.0	8,128	8,128	4,470		82				
Map 31	SR 1245 - Sedgehill Ct	From SR 1129 - Groometown Rd TO END MAINT	0.42	18.0	4,440	4,440	2,442		48				
Map 32	SR 1109 - Pitman Rd	From SR 1007 - Randleman Rd TO END MAINT	0.24	18.5	3,465	3,465	2,370		28				
Map 33	SR 1108 - Ronald Rd	From SR 1109 - Pitman Rd TO END MAINT	0.11	19.0	1,214	1,214	668		13				
Map 34	SR 4003 - Coefield Rd	From SR 1109 - Pitman Rd TO END MAINT	0.16	18.0	1,640	1,640	902		18				
Map 35	SR 1251 - W Sheraton Park Rd	From SR 1007 - Randleman Rd TO END MAINT	0.20	18.0	2,209	2,209	1,264		23				
Map 36	SR 1238 - Kentmere Rd	From SR 1107 - Halsbrook Rd TO END MAINT	0.46	18.5	5,703	5,703	3,526		52				
Map 37	SR 1130 - Newman Davis Rd	From SR 1137 - Drake Rd TO SR 1104 - Old Randleman Rd	1.43	20.0	18,178	18,178	10,737		161		36	15,150	15,150
Map 38	SR 1105 - W Steeple Chase Rd	From SR 1007 - Randleman Rd TO SR 1104 - Old Randleman Rd	0.80	20.0	9,775	9,775	5,567		91		14	8,486	8,486
Map 39	SR 4006 - Steeple Chase Ct	From SR 1105 - W Steeple Chase Rd TO END MAINT	0.09	19.5	1,083	1,083	596		11				
Map 40	SR 4007 - Service Road	From SR 1105 - W Steeple Chase Rd TO END MAINT	0.04	19.0	422	422	51		5				
Map 41	SR 1128 - Concord Church Rd	From SR 1104 - Old Randleman Rd TO END MAINT	0.77	20.5	9,593	9,593	5,441		87				
Map 42	SR 1244 - Tokay Court/Bigpoplar Ln	From SR 1128 - Concord Church Rd TO END MAINT	0.23	18.0	2,499	2,499	1,423		26				
Map 43	SR 4024 - Purdue Rd	From SR 1113 - E Kivett Dr TO SR 4025 - Brook Rd	0.08	19.5	888	888	489		9				
Map 44	SR 4025 - Centenary Rd/Brook Rd	From SR 4024 - Purdue Rd TO SR 4026 - Brook Rd	0.05	19.5	542	542	298		6				
Map 45	SR 4026 - Brook Rd	From SR 4025 - Centenary Rd/Brook Rd TO END MAINT	0.17	19.0	1,858	1,858	1,022		19				
Map 46	SR 4008 - Sutton Ct	From SR 1106 - Sutton Rd TO END MAINT	0.24	20.5	2,847	2,847	1,566		27				
Map 47	SR 1221 - Norman Park Rd	From SR 1392 - S Holden Rd TO END MAINT	0.20	19.0	2,217	2,217	1,219		23				
Map 48	SR 1124 - Robertscourt Rd	From SR 1392 - S Holden Rd TO END MAINT	0.32	20.5	4,272	4,272	2,570		37				
Map 49	SR 1107 - Halsbrook Rd	From SR 1007 - Randleman Rd TO END MAINT	0.33	19.5	3,792	3,792	2,085		38				
Map 50	SR 1252 - Benedict Rd	From SR 1104 - Old Randleman Rd TO END MAINT	0.13	18.0	1,400	1,400	770		15				
TOTAL FOR PROJECT NO. 2022CPT.07.22.20412			17.63	miles	207,545	207,545	115,655	3	2,002	1	50	35,636	35,636